

HERBANICA®  
PURE AUSTRALIAN BOTANICALS

# HERBAL MEDICINES

FRESH PLANT TINCTURES

AUSTRALIAN GROWN, 100% CERTIFIED ORGANIC

HERBANICA Herbal Medicines are:

- All made with herbs grown in Australia
- Based on FRESH plant tinctures prepared within hours of harvesting
- 100% natural product
- 100% Australian Certified Organic
- Made in Australia
- Suitable for vegans

## FREE FROM:

- animal products or testing
- added preservatives, artificial sweeteners, colourings or flavourings
- added sugar, salt, gluten, wheat, yeast, nuts or milk products



Scan with your  
QR code reader



The Pharmaceutical Plant Company Pty Ltd. ABN: 99 154 371 678  
3 Sigma Drive, Croydon South, VIC 3136, Australia.  
T +61 3 9762 3777 F +61 3 9762 9992  
E info@herbanica.com.au W www.herbanica.com.au

Snoozeze®  
(PASSIONFLOWER)



### INGREDIENT:

Passiflora incarnata extract equivalent to fresh herb top flowering 450 mg/mL

### USAGE:

Traditionally used in Western Herbal Medicine to promote sleep; to ease sleeplessness; to ease restlessness.

### DOSAGE:

**Adults:**  
1 - 2.2 mL three times daily or as a single dose 1 hour before bed

**Children 6-12 years:**  
0.3 - 1.1 mL three times daily or as a single dose 1 hour before bed

**Children 2-6 years:**  
0.1 - 0.7 mL three times daily or as a single dose 1 hour before bed

### WARNING:

If symptoms persist contact your healthcare practitioner. Contains ethanol. Use only if cap-seal is unbroken. Store below 30°C.

Respiracote®  
(MARSHMALLOW)



### INGREDIENT:

Althaea officinalis extract equivalent to fresh root 400 mg/mL

### USAGE:

Traditionally used in Western Herbal Medicine to help relieve the symptoms of mild respiratory complaints; as a demulcent to help soothe mild irritation of the upper respiratory tract.

### DOSAGE:

**Adults:**  
2.5 mL three times daily

**Children 6-12 years:**  
0.8 - 1.3 mL three times daily

**Children 2-6 years:**  
0.4 - 0.8 mL three times daily

### WARNING:

Not to be used in children 5 years of age or under without medical advice. If symptoms persist contact your healthcare practitioner. Contains ethanol. Use only if cap-seal is unbroken. Store below 30°C.

Femulate®  
(LADY'S MANTLE)



### INGREDIENT:

Alchemilla vulgaris extract equivalent to fresh herb top flowering 900 mg/mL

### USAGE:

Traditionally used in Western Herbal Medicine to support healthy menstrual function; to support healthy periods; to relieve the symptoms of heavy menstrual periods.

### DOSAGE:

**Adults:**  
2 - 6 mL three times daily

### WARNING:

If symptoms persist contact your healthcare practitioner. Contains ethanol. Use only if cap-seal is unbroken. Store below 30°C.

How to administer

Shake well before use. Can be diluted with water, fruit juice or other fluids if necessary.

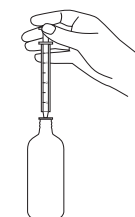

1) Attach syringe to bottle and turn upside down.

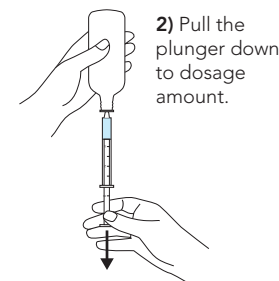

2) Pull the plunger down to dosage amount.

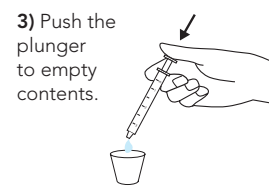

3) Push the plunger to empty contents.



HERBANICA®  
PURE AUSTRALIAN BOTANICALS

# HERBAL MEDICINES

FRESH PLANT TINCTURES

AUSTRALIAN GROWN, 100% CERTIFIED ORGANIC

HERBANICA has evolved from a philosophy of sourcing pure Australian botanicals to create a range of natural products with exceptional characteristics.

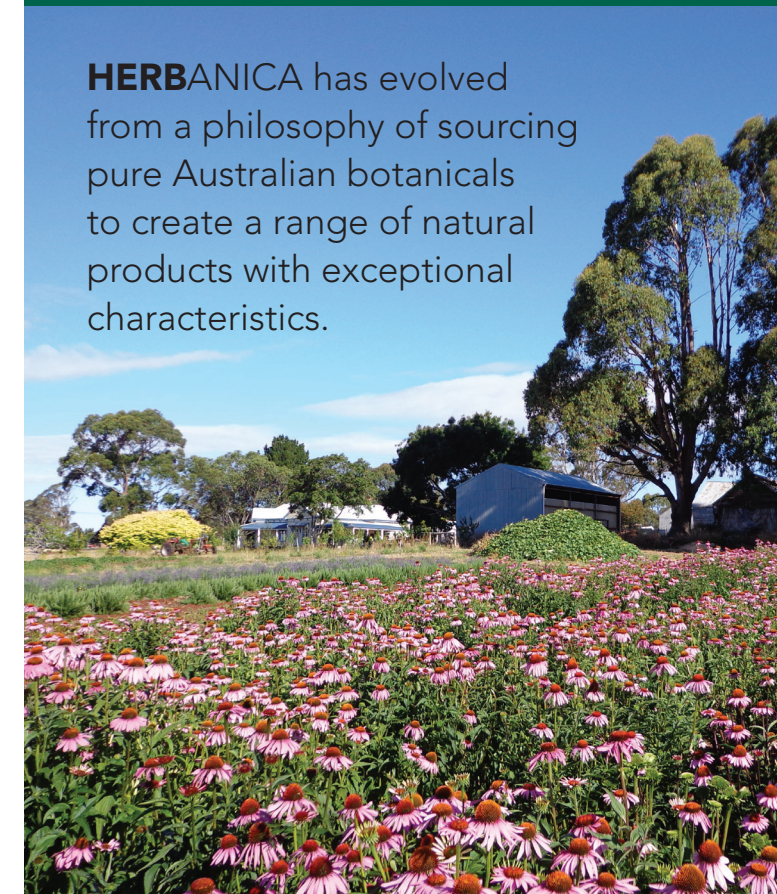

All HERBANICA Herbal Medicines are prepared from herbs grown in Australia and processed within hours of harvesting.

Proudly made in Australia





# HERBAL MEDICINES

**HERBANICA** Herbal Medicines are a NEW range of nine different liquid herbal preparations made in Australia to address specific health conditions or concerns.

All **HERBANICA** Herbal Medicines are made from medicinal herbs grown in Australia and processed within hours of harvesting. Products are 100% Australian Certified Organic (ACO).



**HERBANICA** Herbal Medicines are traditionally used in Western Herbal Medicine for specific health conditions. Use only as directed on the product label and packaging.

**WARNING:** If symptoms persist contact your healthcare practitioner.

## Calmamile® (CHAMOMILE)



**INGREDIENT:**  
Matricaria chamomilla extract equivalent to fresh herb top flowering 450 mg/mL

**USAGE:**  
Traditionally used in Western Herbal Medicine to help relieve the feelings of mild anxiety, nervousness, restlessness or unease; for its calmative, relaxing and mild sedative properties.

**DOSAGE:**  
**Adults:**  
2 - 6 mL three times daily

**Children 6-12 years:**  
1 - 3 mL three times daily

**Children 2-6 years:**  
0.5 - 2 mL three times daily

**WARNING:**  
If symptoms persist contact your healthcare practitioner. Contains ethanol. Use only if cap-seal is unbroken. Store below 30°C.

## Dandetox® (DANDELION)



**INGREDIENT:**  
Taraxacum officinale extract equivalent to fresh whole plant 900 mg/mL

**USAGE:**  
Traditionally used in Western Herbal Medicine to support liver health, bile flow and appetite; for its ability to help support the body's own detoxification processes.

**DOSAGE:**  
**Adults:**  
1.5 - 5 mL three times daily

**WARNING:**  
If symptoms persist contact your healthcare practitioner. Contains ethanol. Drink plenty of water. Use only if cap-seal is unbroken. Store below 30°C.

## Echinamune® (ECHINACEA)



**INGREDIENT:**  
Echinacea purpurea extract equivalent to fresh whole plant 450 mg/mL

**USAGE:**  
Traditionally used in Western Herbal Medicine to support the immune system and for immune health; to support healthy immune function.

**DOSAGE:**  
**Adults:**  
1 - 3 mL three times daily

**Children 6-12 years:**  
0.3 - 1.5 mL three times daily

**Children 2-6 years:**  
0.1 - 1 mL three times daily

**WARNING:**  
If symptoms persist contact your healthcare practitioner. Contains ethanol. Use only if cap-seal is unbroken. Store below 30°C.

## Gutelix® (LEMON BALM)



**INGREDIENT:**  
Melissa officinalis extract equivalent to fresh herb top 450 mg/mL

**USAGE:**  
Traditionally used in Western Herbal Medicine for mild digestive complaints or disturbances.

**DOSAGE:**  
**Adults:**  
1 - 2.2 mL three times daily

**Children 6-12 years:**  
0.3 - 1.1 mL three times daily

**Children 2-6 years:**  
0.1 - 0.7 mL three times daily

**WARNING:**  
If symptoms persist contact your healthcare practitioner. Contains ethanol. Use only if cap-seal is unbroken. Store below 30°C.

## Moodivate® (ST. JOHN'S WORT)



**INGREDIENT:**  
Hypericum perforatum extract equivalent to fresh herb top flowering 400 mg/mL

**USAGE:**  
Traditionally used in Western Herbal Medicine for the relief of mild mood disturbances; to support healthy mood; to help relieve restlessness and/or nervousness.

**DOSAGE:**  
**Adults:**  
1 - 3 mL three times daily

**WARNING:**  
If symptoms persist contact your healthcare practitioner. Contains ethanol. St john's wort affects the way many prescription medicines work including the oral contraceptive pill. Consult your doctor. Use only if cap-seal is unbroken. Store below 30°C.

## Vasguard® (HAWTHORN BERRY)



**INGREDIENT:**  
Crataegus laevigata extract equivalent to fresh fruit 900 mg/mL

**USAGE:**  
Traditionally used in Western Herbal Medicine as a heart tonic; to support cardiovascular health.

**DOSAGE:**  
**Adults:**  
1 - 3 mL three times daily

**WARNING:**  
If symptoms persist contact your healthcare practitioner. Contains ethanol. Use only if cap-seal is unbroken. Store below 30°C.

